

“DIN” STANDARD SOLENOID COILS

+ “LUMINOUS DIN CONNECTOR”

STANDARD COIL ORDERING FOR ALL SOLENOID VALVES

MF-1150C-024U	COIL	24V	50Hz	11W
MF-1150C-048U	COIL	48V	50Hz	11W
MF-1150C-230U	COIL	230V	50Hz	11W
MF-1360C-110U	COIL	110V	60Hz	13W
MF-1900C-024U	COIL	24V	(DC)	19W

DESCRIPTION

- **Only one standard coil** for all solenoid valves.
- Capsuled, humidity and weather proof. Continuous use.
- **DIN 43650 (ISO 4400)** connectors for PG9, PG11 or 1/2" NPT cable guides (**PG9** is the standard *DIN connector* normally supplied and available on stock).
- **IP65** protection (explosion proof version upon request).
- **Luminous gasket** or **luminous DIN connector** incorporated to light up when the coil is energized (upon request).
- The thermal isolation is **+155°C, Class “F”**.

ELECTRICAL INSTALLATION

- All the coils are for continuous use or high frequency of operation and are properly sealed against humidity.
- Verify that the coil supplied with the valve is of the correct tension and current required. If not, replace it with the adequate coil without changing the valve.
- The tension variation that is permitted without affecting the performance of the valve is of -15% to +10% of the nominal tension.
- The rest of the models described in this manual are provided normally with capsulated coils with DIN 43650 (ISO 4400) connections.

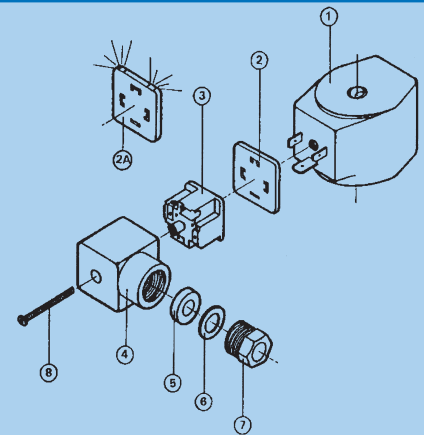

- 1 COIL
- 2 GASKET
- 2a GASKET. With luminous indicator when coil is energised code Nr. 4180-8 (upon request)
- 3 BLOCK WITH ELECTRICAL TERMINALS. maximum section of wiring AWG14 (1,6 mm)
- 4 CONNECTOR WITH OPENING FOR ARMORED CABLE Strain relief “PG9” outside diameter of covered cable from 6 to 8 mm. Upon request luminous connector.
- 5 CABLE SEAL
- 6 WASHER
- 7 CABLE SEAL SCREW
- 8 FIXING SCREW



MF-1150C-230U